



Oaktree Court, Addlestone Park, Addlestone, KT15 1SY



Situated on a quiet tree lined road, just a short walk into the town centre and close to public transport links, is this second floor apartment in an exclusive over 60's 'Retirement Living' development, offered to the market with no onward chain. Accessed via lift or stairs, the apartment is of a good size throughout and consists of a comfortable living room with a door out onto a balcony, further double doors opening in to the modern fitted kitchen with waist height oven and integral hob. The main double bedroom has fitted wardrobes whilst the second bedroom is also a good size double. The bathroom is in keeping with the remainder of the apartment being of modern design yet homely with separated shower and bath. Further benefits include a long lease, care line system in the apartment and communal areas, pretty gardens, a residents lounge, laundry room and an on site house manager who is there Monday to Friday.

Leasehold

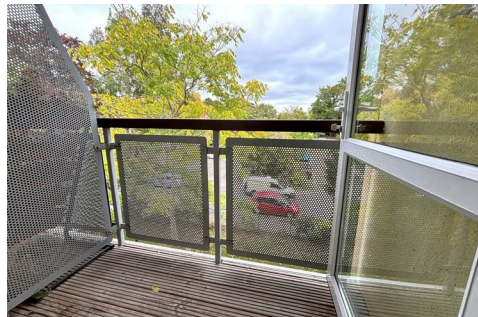

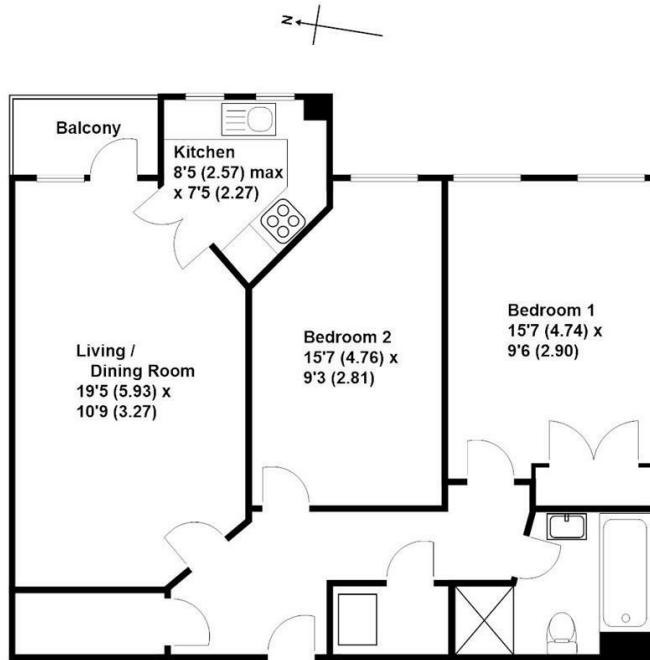

**Approximate Gross Internal Floor Area - 729 sq/ft - 67.8 sq/mtr**

Grants Independent has prepared these sales particulars for general guidance purposes only. They do not form or constitute any part of an offer or contract. The services, systems and appliances listed in these details have not been tested by us, and no guarantee is given to their operational ability or efficiency. Lease details, service charges and ground rent are given as a guide and should be checked by your solicitor prior to exchange of contracts. These plans are not drawn to scale and are for representational purposes only. Created by [www.visionwithin.co.uk](http://www.visionwithin.co.uk)

**EPC Rating: 78 C**





Grants Homes 60 Church Street, Weybridge, Surrey, KT13 8DL  
T: 01932 858885 E: [addestone@grantshomes.co.uk](mailto:addestone@grantshomes.co.uk)

